





KAHAN

FLAUNT YOUR WORK ADDRESS



# GROUND FLOOR



## 1st & 2nd FLOOR

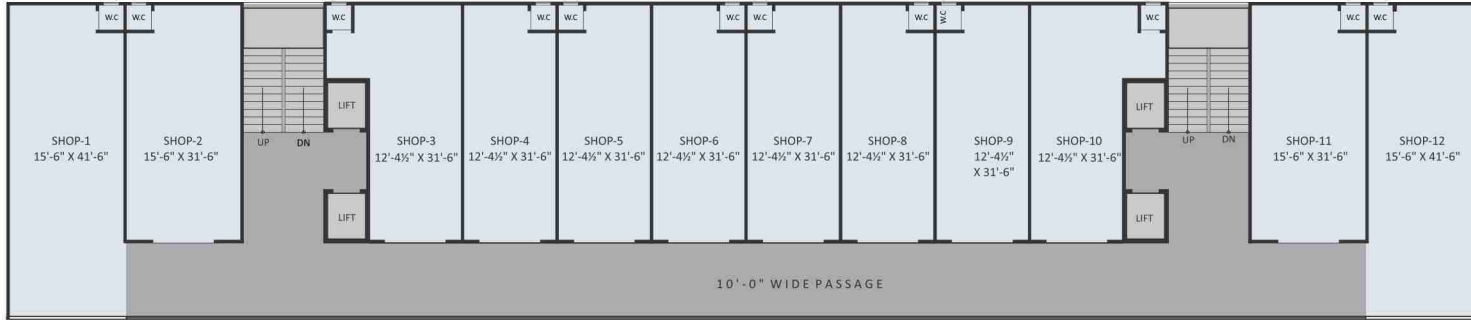

## 3rd & 4th FLOOR

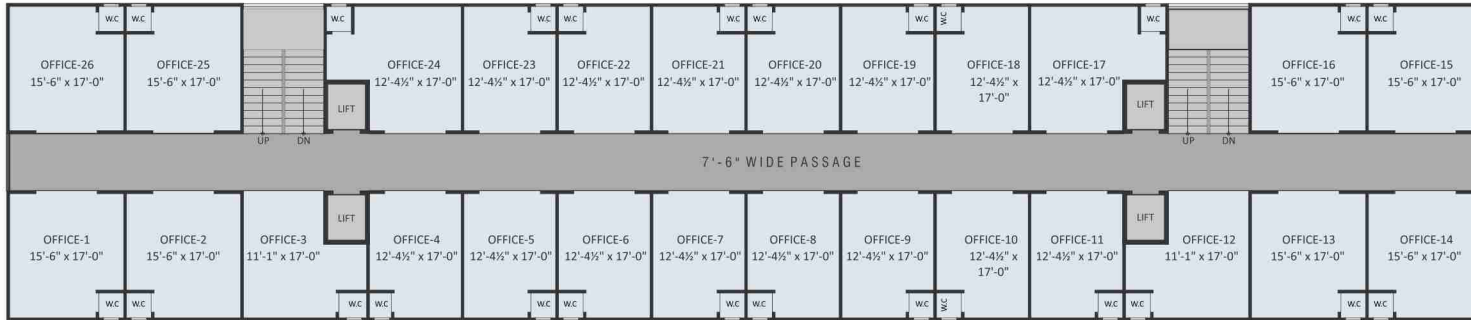

## 5th & 6th FLOOR

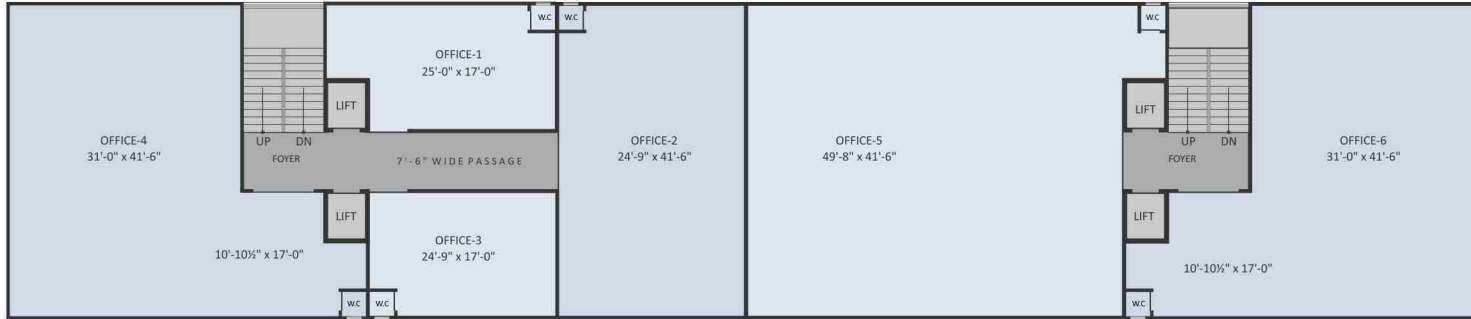

## 7th FLOOR





KAHAN  
*Residency*

2 & 3 Bhk Apartments  
Live in Style

The Home of  
**your dreams.**  
Right where you  
want it to be.

# TYPICAL FLOOR PLAN

BLOCK B

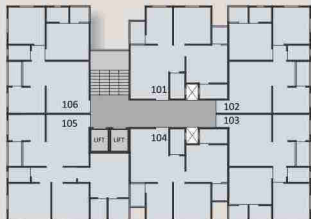

BLOCK C

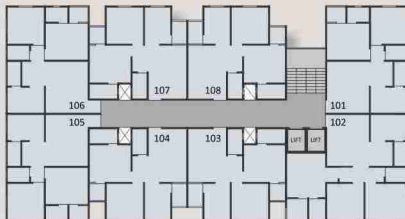

APPROACH ROAD

25'-0" WIDE ROAD



GARDEN

BLOCK A



60.0 MT. WIDE T.P.S. ROAD (S.P.RING ROAD)



# 3 BHK

TYPE-1

UNIT No. :

BLOCK - B 105

BLOCK - C 102

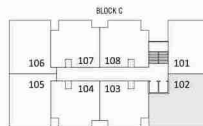
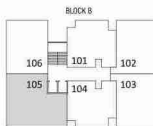



# TYPE-2 2 BHK

UNIT No. :  
BLOCK - B 102, 103, 106  
BLOCK - C 101, 105, 106

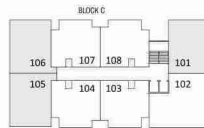
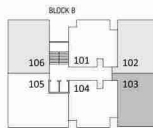

# TYPE-3 2 BHK

UNIT No. :  
BLOCK - B 101, 104  
BLOCK - C 103, 104  
107, 108

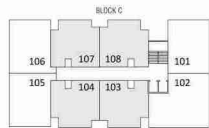
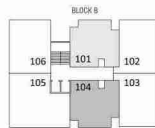



## APARTMENT LEVEL SPECIFICATION

### Building Structure

- Earth Quake Resistant RCC Frame Structure with Brick Masonry

### Wall Finish & Colour Works

- All internal walls with white finish putty over mala plaster
- All external walls with double coat sand faced plaster & standard quality apex paint
- All internal & external fabrication structures in standard quality enamel paint

### Bathrooms & Toilets

- Anti- skid good quality ceramic tiles for flooring
- Designer Glaze tiles on walls up to Lintel level (Dado)
- Premium Quality Plumbing Fittings & Sanitary-ware

### Flooring

- Vitrified Tiles in the entire Apartment. Anti skid Tiles in balconies

### Doors & Windows

- Decorative Wooden Main Door having both side laminate with Quality Lock-set
- Flush Type Painted Internal Doors with wooden frame
- Aluminum sliding windows with standard Gauge sections

### Kitchen

- Black Granite Finished Platform with SS Sink Installation
- Glaze Tiles Dado up-to Lintel Level
- Kota Stone Flooring & Glaze Tiles Dado in Utility Area

### Electrification

- Single Phase Concealed Conduits with Copper Wiring of Standard ISI Brand
- Separate conduits for Television , AC and Telephone points.
- Protective ELCB for each apartment

DEVELOPERS :  **SHIVALIK**  
DEVELOPERS

**SITE ADDRESS & SALES OFFICE :**

KAHAN  
Next to Girivar Pride,  
Near Odhav Ring road Circle,  
Odhav, Ahmedabad.

**FOR BOOKING CONTACT :**

Tel : 9033 534 534

**ARCHITECT :**

MANOJ BHATT  
 **HAPPY**  
DESIGN  
98250 74274

**STRUCTURAL ENGINEERS:**

KETAV JOSHI  
**SHREEJI STRUCTURAL**